



PARTS LIST - 46155

ITEM	QTY	PART NUMBER	DESCRIPTION
1	1	R234144**	BODY, QG-65
2	1	R232875***	SLEEVE, QG-65
3	1	R235571	BACKPLATE, 140MM
4	3	R232022	KEY, QG-65
5	1	VARIABLES	DRAWTUBE ADAPTER (SPECIFY MACHINE)
6	1	RAS-235	AS-235 O-RING
7	1	RM92X3-BN70****	M92 X 3 O-RING
8	3	RM6X1-BN7	M6 X 1 O-RING
9	6	RM6X30SCS	M6 X 30 SOCKET CAP SCREW
10	12	RM10X35SCS	M10 X 35 SOCKET CAP SCREW
11	1	R8MMHEXLLA	8MM LONG ARM HEX KEY (NOT SHOWN)
12	1	R232849*	SEAL #65 COLLET

* FOR CHUCKS MARKED REV A OR HIGHER

** BODY 234144 REV 0, OR A FROM CHUCK 46155 REV 0, OR A IS NOT INTERCHANGEABLE WITH BODY 234144 REV B, AND HIGHER, FROM CHUCK 46155 REV B, AND HIGHER

*** SLEEVE 232875 REV 0 FROM CHUCK 46155 REV 0, OR A IS NOT INTERCHANGEABLE WITH SLEEVE 232875 REV A, AND HIGHER, FROM CHUCK 46155 REV B, AND HIGHER

**** ONLY REV 0 AND A 46155 CHUCKS USE M94 X 3 O-RING (RM94X3-BN70)

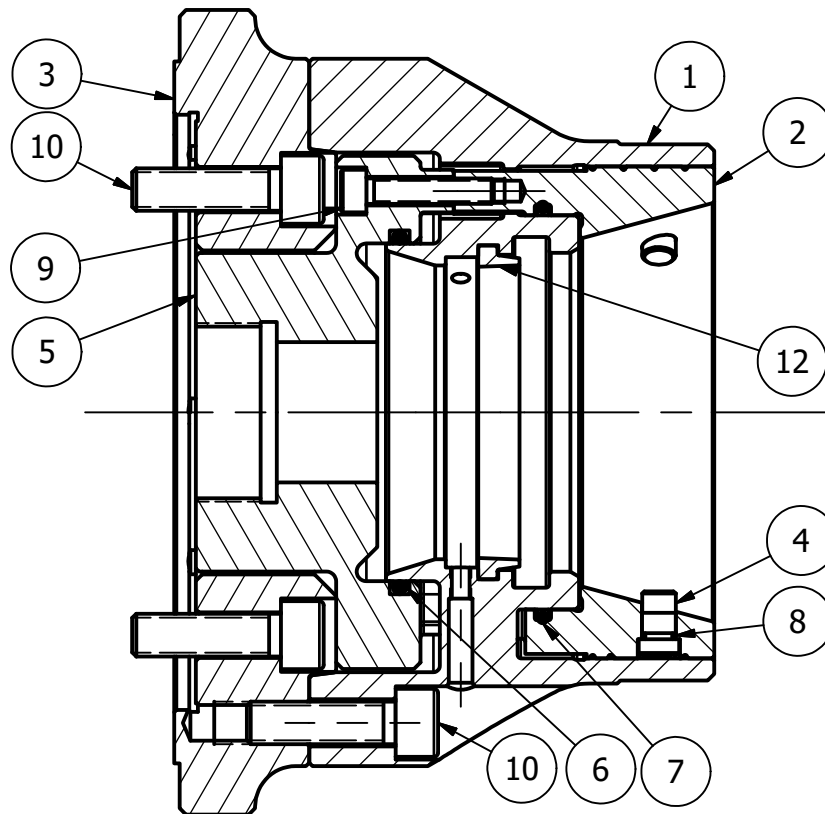

QUESTIONS, COMMENTS OR CONCERNS?
PLEASE VISIT WWW.ROYALPRODUCTS.COM

ROYAL PRODUCTS
200 OSER AVE.
HAUPPAUGE NY 11788

R220689 rev.B

