

PARTS LIST - 46160

ITEM	QTY	PART NUMBER	DESCRIPTION	
1	1	R234140***	BODY, QG-80	
2	1	R235550	BACKPLATE, A2-5	
3	1	R232873****	SLEEVE, QG-80	
4	3	R232020	KEY, QG-80	
5	1	VARIES	DRAWTUBE ADAPTER (SPECIFY MACHINE)	
6	6	RM12X45SCS	M12 X 45 SOCKET CAP SCREW	
7	6	RM8X35SCS	M8 X 35 SOCKET CAP SCREW	
8	6	RM10X30SCS*	M10 X 30 SOCKET CAP SCREW	
B 9	1	RAS-240	AS-240 O-RING	B
10	1	RM107X2.5-BN70*****	M107 X 2.5 O-RING	
11	3	RM6X1-BN7	M6 X 1 O-RING	
12	1	R10MMHEXLLA	10MM LONG ARM HEX KEY (NOT SHOWN)	
13	1	R8MMHEXLLA*	8MM LONG ARM HEX KEY (NOT SHOWN)	
14	1	R232858**	SEAL #80 COLLET	

* (6) 7/16-14 X 1-1/4 CAP SCREWS (R7/16-14X1-1/4SCS) AND A 3/8" HEX KEY (R3/8HEXLLA) WILL BE SUPPLIED FOR MACHINES REQUIRING INCH MOUNTING BOLTS (HAAS)

** FOR CHUCKS MARKED REV A OR HIGHER

*** BODY 234140 REV 0, OR A, OR B FROM CHUCK 46160 REV 0, OR A IS NOT INTERCHANGEABLE WITH BODY 234140 REV C, AND HIGHER, FROM CHUCK 46160 REV B, AND HIGHER

**** SLEEVE 232873 REV 0, OR A FROM CHUCK 46160 REV 0, OR A IS NOT INTERCHANGEABLE WITH SLEEVE 232873 REV B, AND HIGHER, FROM CHUCK 46160 REV B, AND HIGHER

***** ONLY REV 0 AND A 46160 CHUCKS USE AS-156 O-RING (RAS-156)

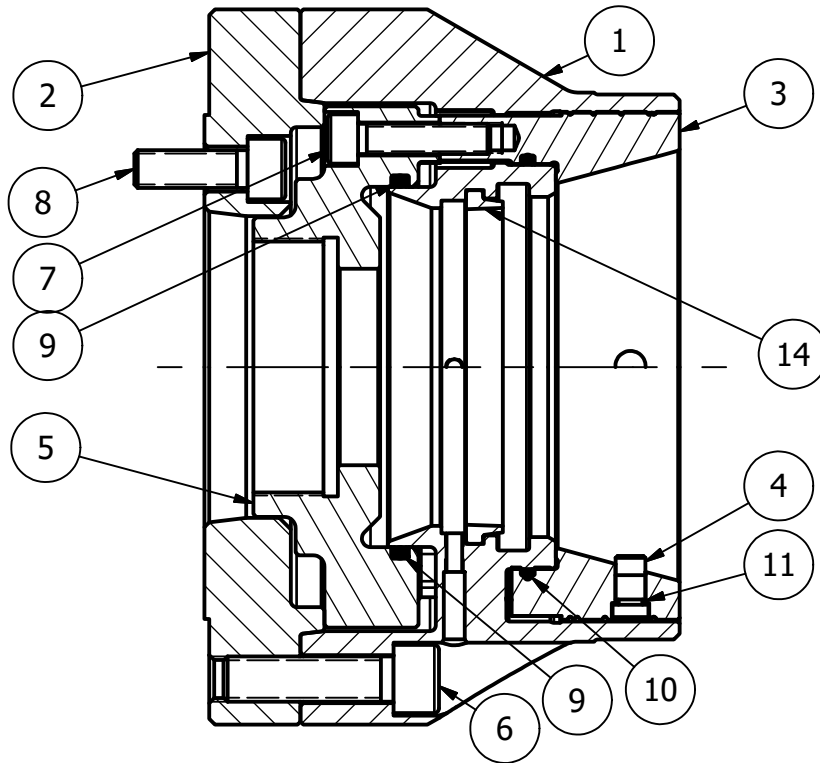

QUESTIONS, COMMENTS OR CONCERNS?
PLEASE VISIT WWW.ROYALPRODUCTS.COM

ROYAL PRODUCTS
200 OSER AVE.
HAUPPAUGE NY 11788

R220647 rev.B